

Flowseal EPW (Wall Sealer)



Description

Flowseal EPW is a pigmented, water-based epoxy, hygienic wall sealer that is compliant to CSM® (Cleanroom Suitable Materials) requirements.

Uses

Flowseal EPW is suitable for sealing walls in a variety of locations such as cleanrooms and hospitals.

Benefits

- Emissions of TVOC at 23°C are not exceeding the limiting values for ISO-ACC_m Class > -9.6 according to ISO 14664-8
- Hygienic
- Vapour permeable; allows substrate to breath
- Can be applied to damp substrates
- Enhances appearance of working environment
- Solvent free; low odour
- Easy to clean and maintain

Project References

Available on request.

Standard Colour Chart



White



Beige 326



Light Grey



Mid Grey 280

System Design

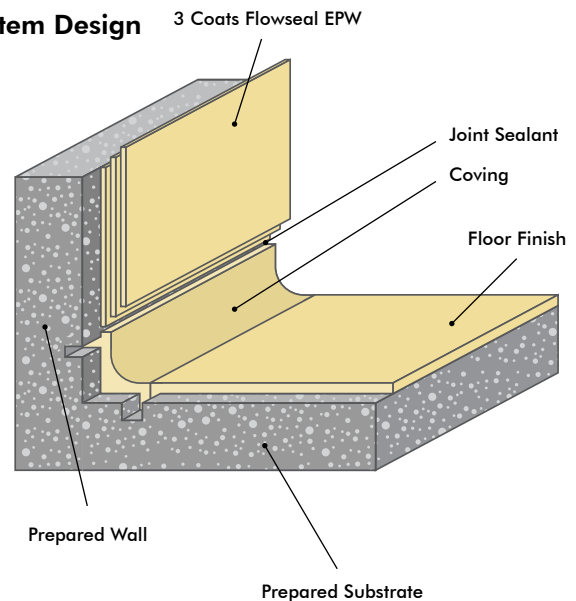



Cleanroom®
Suitable
Materials

Flowcrete Group Limited
Report No. FL 1607-835

Flowseal EPW Wall
Outgassing VOC (23°C / 90°C):
ISO-ACC_m Class > -9.6/tested

Flooring & Coating

Model Specification

Product: Flowseal EPW
Finish: Gloss
Thickness: 0.20mm Dry Film Thickness (3 coats)
Colour: _____
Preparatory work and application in accordance with suppliers instructions.
Manufacturer: Flowcrete Middle East FZCO
Telephone : Customer Service +971 4 886 4728

Substrate Requirements

A smooth, dense substrate such as finishing plasters or similar is recommended to ensure the best finish is achieved.

Products Included in this System

Flowseal EPW

For actual coverage rates, refer to the appropriate project specification.

Detailed application instructions are available upon request.

Installation Service

The installation should be carried out by a Flowcrete approved applicator with a documented quality assurance scheme. Obtain details of our approved contractors by contacting our customer service team or enquiring via our website at www.flowcrete.ae

Environmental Considerations

The finished system is assessed as non-hazardous to health and the environment. The long service life and seamless surface reduce the need for repairs, maintenance and cleaning. Environmental and health considerations are controlled during the manufacture and application of the products by Flowcrete staff and fully trained and experienced contractors.

Focus on the Floorzone

Flowcrete Middle East FZCO is a division of the Flowcrete Group, world leaders in specialist industrial and commercial flooring. Systems available include: underfloor heating systems, floor screeds, surface damp proof membranes, decorative floor finishes, seamless terrazzo, car park deck waterproofing and corrosion protection systems... to name just a few. Our corporate objective is to satisfy your flooring needs.

Technical Information

The figures that follow are typical properties achieved in laboratory tests at 20°C and at 50% Relative Humidity.

Fire Resistance	B _{FL} - s1 (EN 13501-1)
Thermal Resistance	Tolerant up to 60°C
Vapour Permeability	ASTM:E96:90 20g/m ² /mm/24hr
Chemical Resistance	Contact Technical Department
TVOC (at 23°C)	ISO-ACC _m Class >-9.6 (ISO 14644-8)

Speed of Cure

	10°C	20°C	30°C
Overcoating Time	16 hrs	8 hrs	6 hrs
Full chemical cure	14 days	7 days	6 days

Low relative humidity and good ventilation are pre-requisites to achieving the above drying times.

Important Note

Flowcrete's products are guaranteed against defective materials and manufacture and are sold subject to its standard Terms and Conditions of Sale, copies of which can be obtained on request.

Further Information

To ensure you are specifying a fit for purpose flooring for your project please consult our Technical Advisors on the number below or visit our website to register your interest in specifying one of the most durable floors on the market.